

Replacement Parts List

NOTE: If requested color is not available, similar color will be substituted.

| Part | Cost | Quantity | Total Cost |
|---------------------|--------------|----------|------------|
| Crotch Strap/Buckle | \$4.99 | X _____ | = \$ _____ |
| Harness Strap |\$2.00 | X _____ | = \$ _____ |
| Full Wrap Seat Pad | \$42.00 | X _____ | = \$ _____ |
| Harness Retainer | ...\$1.50 | X _____ | = \$ _____ |
| Locking Clip |\$2.50 | X _____ | = \$ _____ |
| Tether Kit |\$9.99 | X _____ | = \$ _____ |
| Latch Kit |\$24.99 | X _____ | = \$ _____ |
| Instructions |\$0.00 | X _____ | = \$ _____ |

Merchandise Total \$ _____

Shipping and handling: \$ _____

| | | | |
|---------------------|-------------|-------------------------|--------------|
| Up to \$25.00 |\$5.95 | \$100.01 to \$150.00 |\$10.95 |
| \$25.01 to \$50.00 |\$6.95 | \$150.01 to \$200.00 |\$11.95 |
| \$50.01 to \$75.00 |\$8.95 | \$200.01 and up |\$13.95 |
| \$75.01 to \$100.00 |\$9.95 | Outside Continental USA | \$10.00 |

Sales Tax \$ _____
 (Indiana, California, Arkansas, and Massachusetts residents add applicable sales tax.)

Grand Total \$ _____

No shipping and handling on instructions for quantities under 6. Add \$.50 for each instruction over 6, then add applicable shipping and handling.

Fill Out For Credit Card

Visa Mastercard

Card Exp. Date: _____

Cardholder's Name: _____

Card Number: _____

Signature _____

CUT ON DOTTED LINE

Eng. 4358-3395F

Touriva®/Comfort Ride Regal Ride™ Deluxe Convertible Owner's Manual

www.djgusa.com

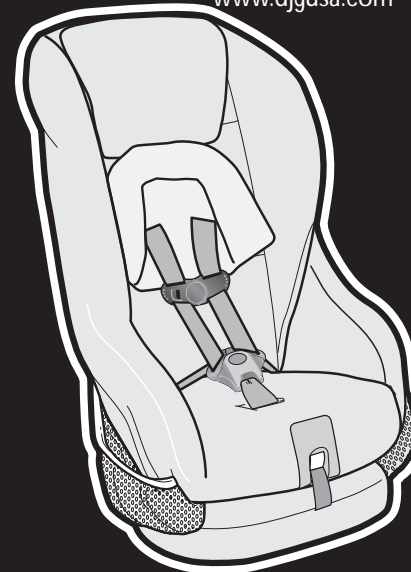

This child restraint is designed for use by children whose:

Weight:
 5-40 pounds
 (2.3-18 kg)

Height:
 19-43 inches
 (48-110 cm)



Read all instructions
BEFORE USING
 this child restraint.
 KEEP INSTRUCTIONS FOR FUTURE USE.

▲ IMPORTANT!

Failure to follow the warnings on the labels and in the instruction manual can result in the death or serious injury of your child.

Para recibir las instrucciones en español, llame al 1-800-544-1108 o solicítase por escrito al dirección por arriba.

Before You Begin...

Thank you for choosing this car seat, referred to throughout this manual as a child restraint. The DJG family is committed to creating a child restraint with the most comfort and convenience available today.

Remember, parents are a child's first teachers and examples. If you always buckle your seat belt, your child will think it is the natural thing to do. Make it a firm rule that the vehicle does not go until everyone is buckled up. Make no exceptions.

No one can predict if use of a child restraint will prevent injury or death in a particular crash. However, combined with careful driving, proper use of a child restraint can lower a child's risk of injury or death in most crashes.

Your child's safety is worth the time it will take to read and follow these instructions. After reading, if you still have questions or have any problems with this child restraint, please contact our Consumer Relations Department at:

Dorel Juvenile Group, Inc.

Website: www.djgusa.com
 Fax: 1-800-207-8182
 Mailing Address: Dorel Juvenile Group, Inc.
 P.O. Box 2609
 Columbus, IN 47202-2609
 Telephone: 1-800-544-1108
 7 A.M. to 6 P.M. EST M-TH
 7 A.M. to 4:30 P.M. EST FRI

On the back of the shell there is an expiration date for use of this child restraint. Do not use this seat after the expiration date.

Table of Contents

- Warnings2-4
- Registration and Recall.....5
- Warm Weather Use and Aircraft Installation5
- Understanding Your Vehicle6-7
- Child Restraint Parts.....8-9
- Choosing Restraint and Position10
- Preparing Child Restraint to Fit Your Child11-13
 - Harness Height12-13
- Accessories (On Select Models)14
- Securing Your Child in Child Restraint.....15-16
- Removing Child From Child Restraint17
- Reclining the Child Restraint18
- Choosing LATCH or Vehicle Belts19
- Knowing Your Vehicle Belts20-21
- Locking Clip22-23
- Rear-Facing Use24
- Rear-Facing Installation.....25
 - Vehicle Belt26-27
 - LATCH28-31
- Forward-Facing Use32
- Forward-Facing Installation33
 - Vehicle Belt34-35
 - LATCH36-38
- Adjusting the Top Anchorage (Tether) Strap.....39-41
- Removing Seat Pad for Cleaning42-44
- Reinstall Harness45-46
- Trouble Shooting47
- Warranty48
- Replacement Parts Order Form49-50

! WARNING

Failure to follow these warnings can result in the serious injury or death of your child. To help you recognize those instructions which are most critical for your child's safety, we use this symbol **!**:

! According to accident statistics, children are safer when properly restrained in the rear seating positions than in the front seating positions.



! Never place a child rear-facing in a seating position with an active frontal airbag.

! This child restraint must always face the rear of the vehicle and be in the fully reclined position when the child weighs between 5-35 lbs. (2.3-16 kg) and is less than one year old.

! Never place a child less than one-year old forward facing.

! Check vehicle instructions for more information about air bag/child restraint use.

! For vehicles with an air bag, but without a back seat, refer to your vehicle owners manual.

! Make sure the harness height is correct for your child's size.

! The harness must be snug.

! Do not lubricate buckles and fasteners.

! WARNING

! The vehicle or LATCH belt must stay tight at the belt path. When you switch from one mode to the next, review the sections of this instruction manual that apply to that mode. If you don't, your child could be injured or killed.

! Never take your child out of the child restraint or try to tend to your child's needs while the vehicle is moving. Never leave child unattended.

! Do not use a child restraint with damaged or missing parts.

! Do not use cut, frayed or damaged harnesses.

! Do not substitute parts or try to modify the child restraint in any way.

! Do not use a child restraint that has been in a crash. You must get a new child restraint.

! Use the child restraint only on vehicle seats that face forward. Do not use on seats that face the sides or rear of the vehicle.

! Check the vehicle or LATCH belt before each use. Use only if the belt can be tightened properly and securely.

! This child restraint should be securely belted in the vehicle even when not in use. In a crash or sudden stop, an unsecured child restraint could injure other occupants.

WARNING

- ▲ Do not use this child restraint if the midpoint of your child's head is above the top of the child restraint.**
- ▲ Dorel Juvenile Group does not recommend the use of any child restraint accessories except those provided by DJG.**
- ▲ Never allow any child to play with this child restraint; it is not a toy.**
- ▲ Secure the top anchorage strap (tether) provided with this child restraint as specified in both the vehicle and child restraint manufacturer's instructions.**
- ▲ Do not remove any of the warning labels or other labels on the child restraint.**
- ▲ Do not use this child restraint without the seat pad.**
- ▲ Placing your child in a hot child restraint may result in burns.**
- ▲ Read instructions for other warnings.**

General and Warm Weather Use

To help protect your vehicle seat's upholstery from damage, use a towel underneath and behind child restraint.

To avoid your child being seriously burned, take the following precautions:

1. Park in the shade or where sun does not directly hit the child restraint.
2. Cover the child restraint with a sheet or blanket when not in use.
3. Check for hot seat and buckles before placing child in child restraint.

Registration and Recall Information

Child restraints could be recalled for safety reasons. You must register this restraint to be reached in a recall. Send your name, address and the restraint's model number and manufacturing date to:

Dorel Juvenile Group, Inc.
PO Box 2609, Columbus, IN 47202-2609
Attn: Consumer Relations or visit www.djgusa.com
or call 1-800-544-1108

For recall information, call the U.S. Government's Vehicle Safety Hotline at 1-888-327-4236 (TTY: 1-800-424-9153), or go to <http://www.NHTSA.gov>.

Aircraft Installation

This child restraint is certified for aircraft use. Use on forward-facing aircraft seats only and in a position where the lap belt can be tightened securely. This child restraint is installed in an aircraft seat the same way it is installed in the vehicle.

Use the child restraint only with F.A.A. certified equipment. Contact the airline prior to taking a child restraint on board in order to comply with their specific regulations.

Understanding Your Vehicle

Your vehicle's features may be considerably different than those pictured here. Consult your vehicle owner's manual to help identify your vehicle's specific features.

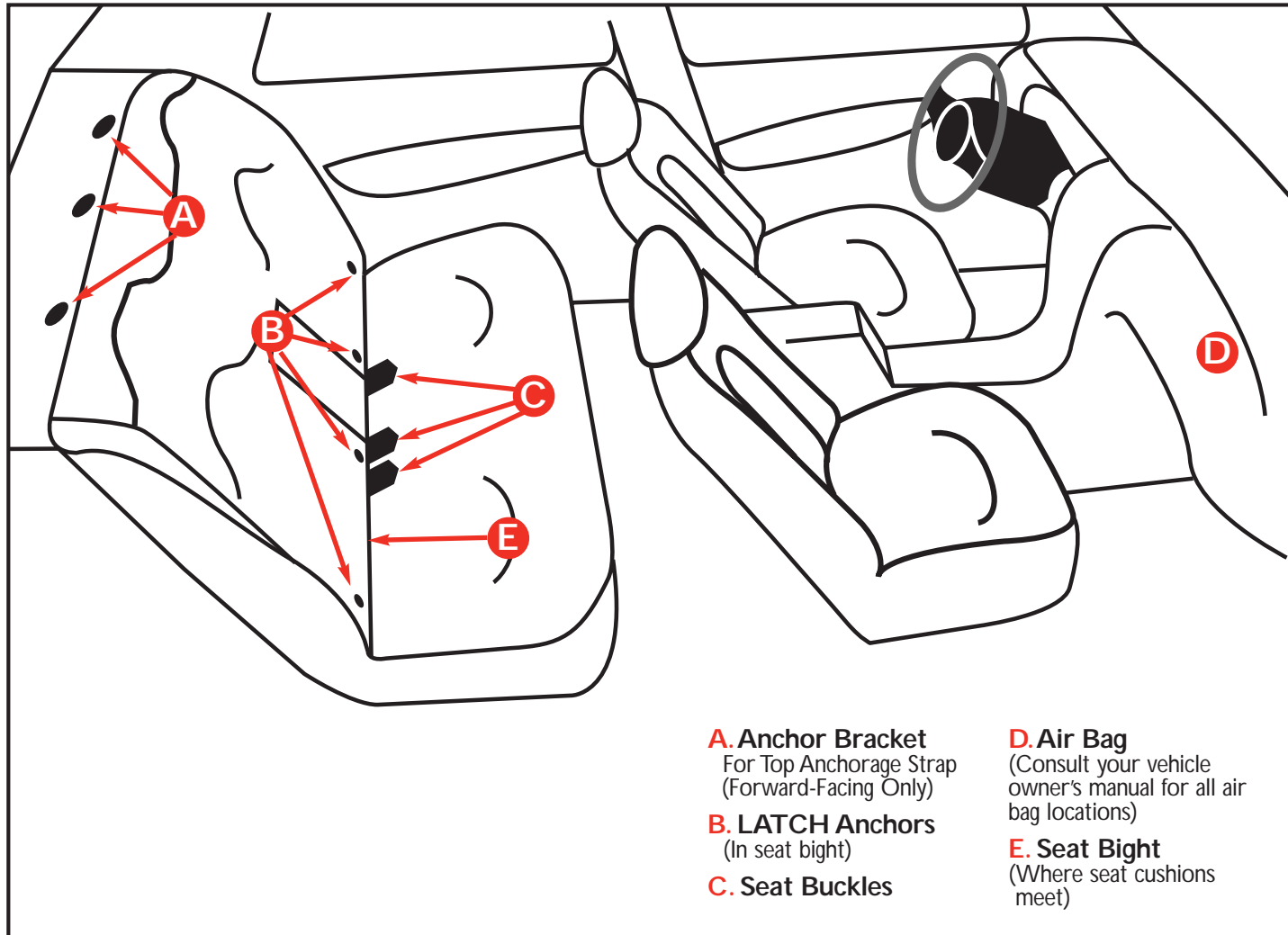

Child Restraint Parts

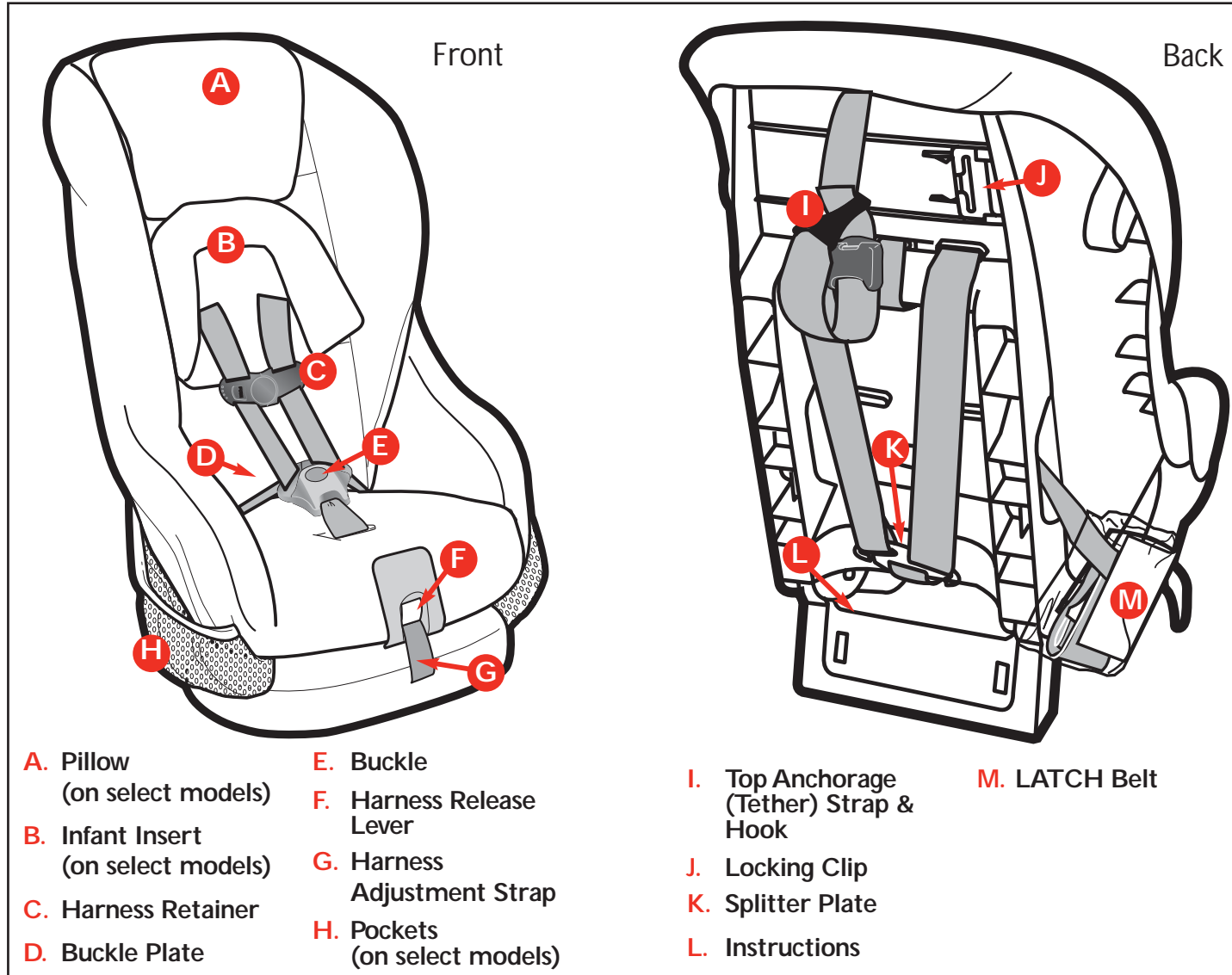

Choosing Restraint and Position

Your child's height, weight and age determine how your child restraint should be placed in the vehicle and which restraint should be used.

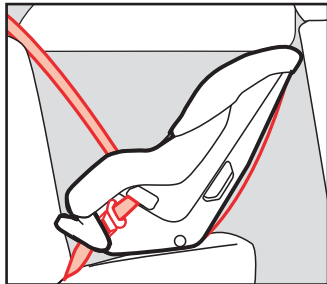

**5-35 lbs (2.3-16 kg)
19-36 in. (48-91 cm)**

**Rear-Facing using
5-point harness**
Child and child restraint
face the back of the
vehicle and are placed in
the back seat.

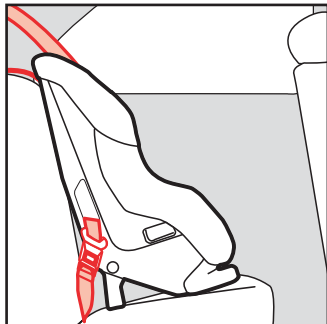

**22-40 lbs (10.1-18 kg)
34-43 in. (85.1-110 cm)
and Over 1 Year Old**

**Forward-Facing using
5-point harness**
Child and child restraint
face the front of the
vehicle and are placed in
the back seat.

Preparing Child Restraint to Fit Your Child

You **MUST** make these adjustments with your child before you install the child restraint in the vehicle.

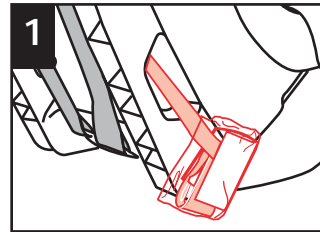

Make sure LATCH belt packaging is pulled free of child restraint shell.

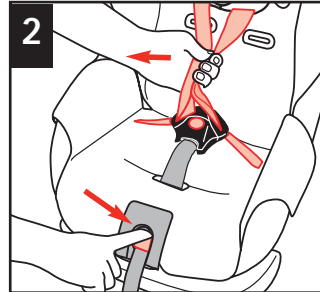

Loosen harness by pushing down on the harness release lever while pulling out on the harness.

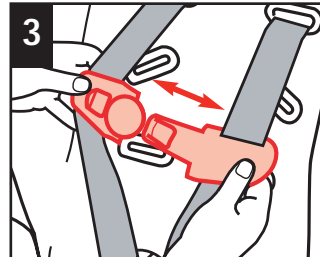

Press on harness retainer release button and pull apart.

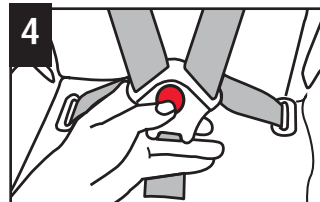

Press red button on buckle to release the buckle plates. Place harness over sides of child restraint.



Place the child's bottom and back flat against the child restraint. This will increase comfort and allow the harness to properly tighten.

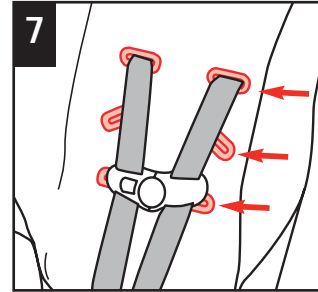

Determine which set of harness guide slots works best for your child. Adjust if needed.

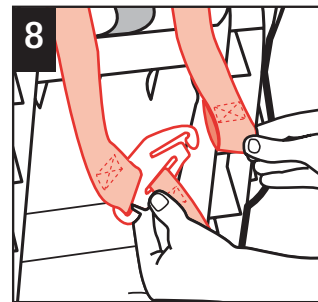

To change harness location:
From the back of the seat, remove harness from splitter plate.

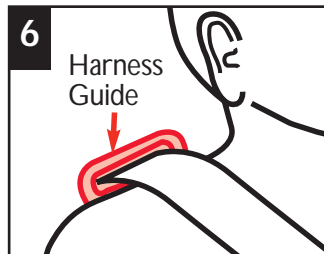

Check Harness Height

Rear-Facing Position: Harness guide must be **even with or just below** the shoulders.

If the bottom harness guides are above the child's shoulders, **do not** use this child restraint. Use an infant child restraint instead.

Forward-Facing Position: Harness guides must be **even with or just above** the shoulders.

If the top harness guides are below the child's shoulders, **do not** use this child restraint. Use a belt-positioning booster instead.

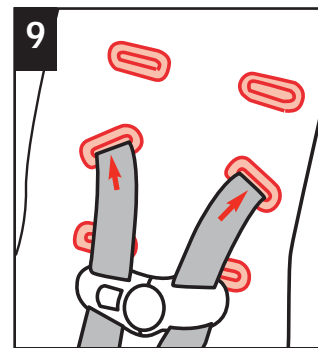

Pull harness through the harness guides from the front.

Rethread harness into new harness guide location. Refasten harness to splitter plate. Make sure harness does not twist.

⚠ WARNING
Failure to reattach the harness correctly, can result in serious injury or death.

Accessories (On Select Models)

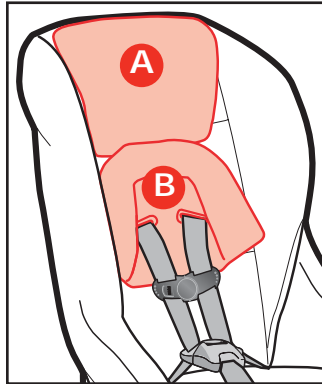

Pillow:
The pillow (A) provides extra comfort for your toddler.

To remove pillow:
Pull apart fastening strips and remove pillow. To replace, thread lower set of fastening strips through top harness guides. Pull top fastening strips over top of shell and attach on the back side of shell.

Infant Insert:
When using insert (B), make sure insert does not cover your infant's face in any way. Remove the insert for older babies and toddlers.

To remove insert:
Unthread the harness from the harness bracket. Remove harness guides and remove insert (see sections "To Change Harness Location" and "Removing Seat Pad for Cleaning"). Replace harness guides, rethread harness and reattach to splitter plate. Reverse to replace infant insert.

Securing Your Child in the Child Restraint

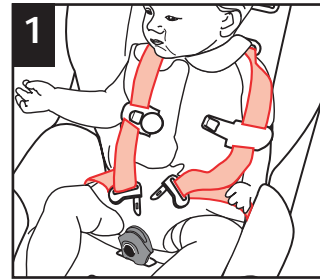

1 Position harness straps over the child's shoulders.

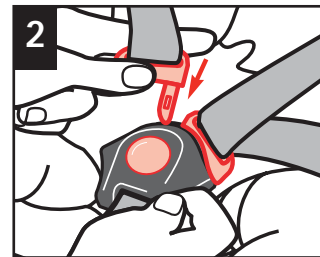

2 Push each buckle plate into buckle until you hear a "click". Remember to always pull up on harness straps to make sure buckle is locked tightly.

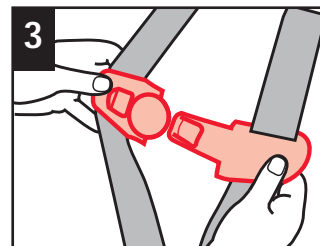

3 Snap the harness retainer together.

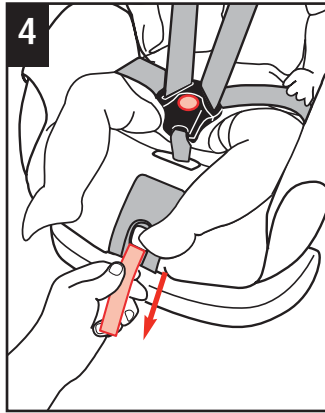

4 Pull on harness adjustment strap to tighten harness snugly.

NOTE: A snug strap should not allow any slack. It lies in a relatively straight line without sagging. It does not press on the child's flesh or push the child's body into an unnatural position.

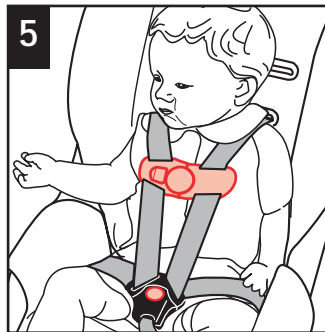

5 Position the harness retainer at mid-chest (even with arm pits), away from the child's neck.

⚠ WARNING:
Failure to fasten and tighten the harness system correctly with each use can result in serious injury or death.

Removing Your Child From the Child Restraint

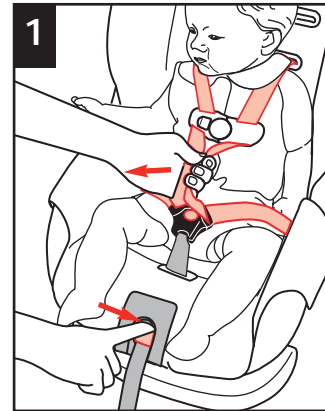

1 Loosen harness by pushing down on the harness release lever while pulling out on the harness.

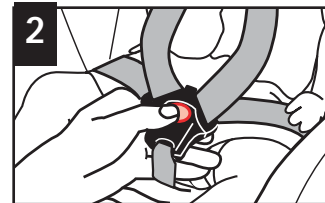

2 Press red button on buckle to release the buckle plates.

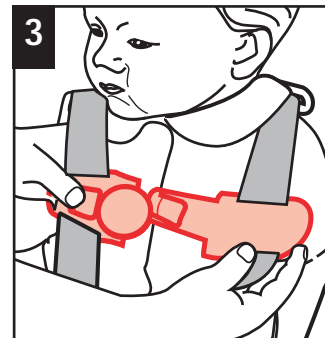

3 Press on release button and pull apart. Place harness over sides of child restraint. Remove child.

Reclining the Child Restraint

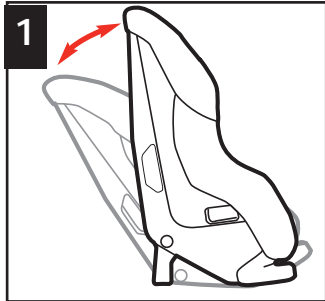

This child restraint has 2 recline positions: Upright (forward-facing only) and Reclined.

Rear-facing - Must be fully reclined.

Forward-Facing - Reclined or upright.

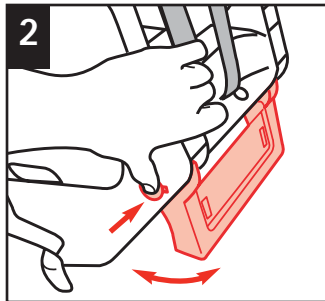

To recline, push in on red button on side of shell and rotate recline stand up into shell.

For upright position, rotate out on recline stand until it locks into place.

Choosing LATCH or Vehicle Belts

The LATCH System

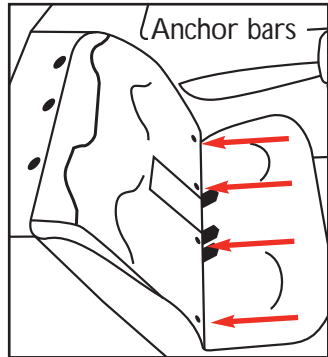

LATCH means **L**ower **A**nchors and **T**ethers for **C**hildren. Not all vehicles manufactured before September 2002 were equipped with LATCH.

The LATCH system allows a child restraint to be secured in the vehicle without using the vehicle belt system and can **ONLY** be used in vehicles that have the anchor bars installed.

Check your vehicle owners manual to see which seating positions may be equipped with the LATCH system.

Vehicle Belts

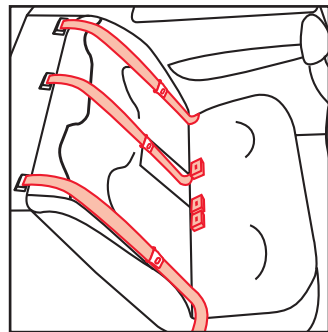

If LATCH is not an option, you will use your vehicle's belts. In most cases you will use the lap/shoulder belt combination. There are some vehicle belts that will not work with a child restraint or will require special attention. See next page for specific instructions.

Knowing Your Vehicle Belts

Not all vehicle belts will work with this child restraint. You must determine if your vehicles belts are compatible with this child restraint. If you will use the LATCH system, refer to the LATCH section.

ELR - Emergency Locking Retractor Belts

Definition: These belts only lock in a sudden stop or crash. To see if you have this type of belt, pull on the lap belt, let it return part way, then pull on it again. If it moves freely, it is an ELR belt and the child restraint could work loose during normal driving. Refer to your vehicle owner's manual.

ELR shoulder belts either require a locking clip or cannot be used with any child restraint.

ELR lap-only belts must be replaced with a manual belt; contact your vehicle dealer. A locking clip will not correct this problem.

Automatic/Passive vehicle seat belts

Automatic (passive) 2-point belt has no lap belt. You must install a lap belt to secure a child restraint. You may also need to install an extra lap belt for an automatic 3-point belt. Refer to the vehicles owner's manual. A locking clip will not correct this problem.

Vehicle belt too short

Contact your vehicle dealer for a seat belt extender.

Belts in center of the door or side panel (A) or middle of the vehicle seat cushion (B).

You must move the child restraint to another seating location. A locking clip will not fix this problem.

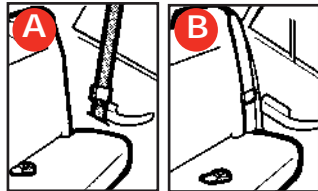

See "Locking Clip" section.

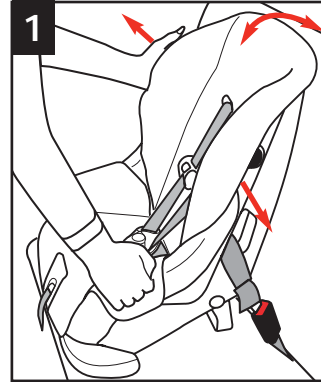

Manual Belts

Manual lap belts are common in the center rear seat and can allow the child restraint to loosen when it is tilted or jarred. After tightening the lap belt securely, tilt and push the child restraint forward and to both sides. If no loosening occurs, your child restraint should be secure.

If loosening does occur, try the following: If the buckle plate slides on the belt, turn the buckle plate over. If the buckle slides, turn the buckle. Refasten the vehicle lap belt. The release button should face **out** after twisting so that it is easy to reach in an emergency.

If the lap belt continues to loosen, the child restraint must be moved to another location in the vehicle. A locking clip will not correct this problem; see your vehicle owner's manual.

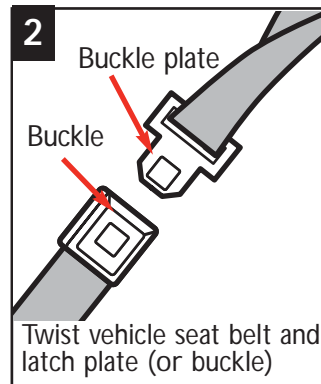

⚠ WARNING

Failure to check and adjust the manual belt as described above can result in serious injury or death.

Locking Clip

NOTE: Remove the locking clip when the seat belt is not being used with a child restraint. The locking clip is located on the back of the seat. **A locking clip will not fix all types of seat belt problems.**

Before you put your child restraint in the vehicle, buckle the lap/shoulder belt. Pull on the lap belt portion. If it loosens or slips, you must either use a locking clip to hold the seat belt tight or move the child restraint to another seating location.

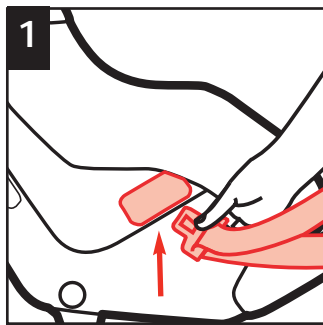

1 Thread both vehicle lap and shoulder belts through the slot (as shown) and out other side. Buckle. Pull up on shoulder belt until all slack is out and lap belt is tight.

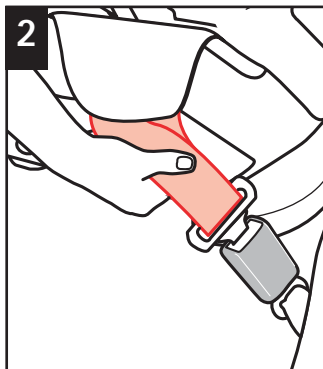

2 Grasp both vehicle belts together just behind the buckle plate and unbuckle. **NOTE:** If the buckle plate ends up behind the child restraint, grasp the belts to the outside of the child restraint, as close to the buckle plate as possible.

22

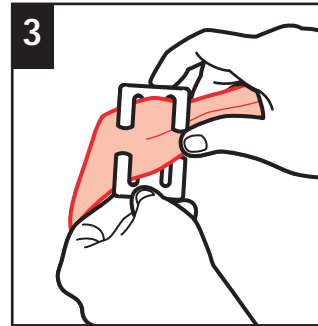

3 Thread both portions of the vehicle belt onto the locking clip, as close to the buckle plate as possible.

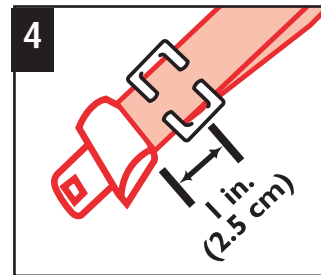

4 Position locking clip about 1 in. (2.5 cm) from vehicle belt's buckle plate.

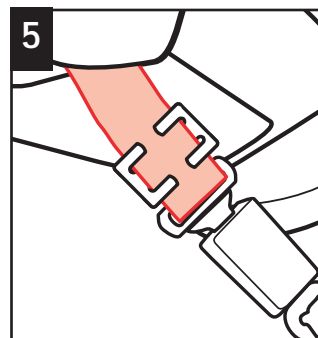

5 Rebuckle belt. Lap belt portion should now be tight. If not, remove locking clip and repeat all steps.

23

Rear Facing Use: 5-35 lbs. (2.3-16 kg), 19-36" (48-91 cm).

Rear-Facing Use

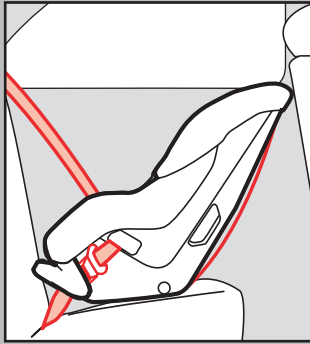

Lap/Shoulder Belt

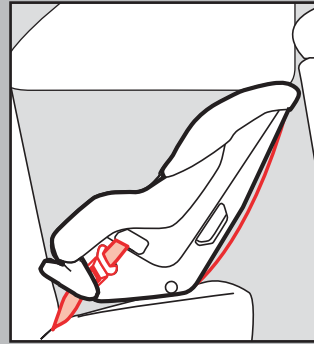

Lap Belt

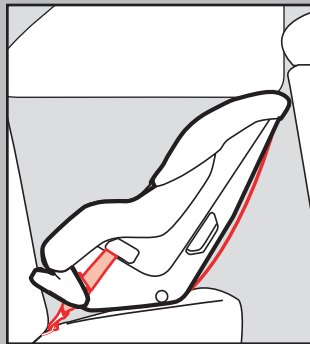

LATCH Belt

Refer to the "Choosing Restraint and Position" section to determine if your child should be in the rear-facing position.

⚠ WARNING:

This child restraint must always face the rear of the vehicle and be in the fully reclined position when the child weighs between 5-35 lbs. (2.3-16 kg) and is less than one year old.



Never place a child rear-facing in a seating position with an active frontal airbag.

Rear-Facing Installation

After deciding whether to use your Vehicle Belts or LATCH, be sure to read the warnings below as they pertain to both systems.

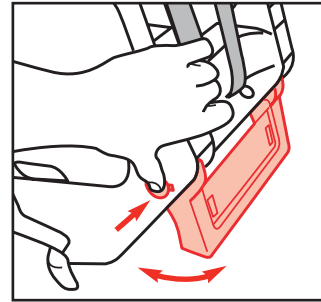

To use rear-facing the child restraint **MUST** be fully reclined.

To fully recline, push in on red button on side of shell and rotate recline stand up into shell.

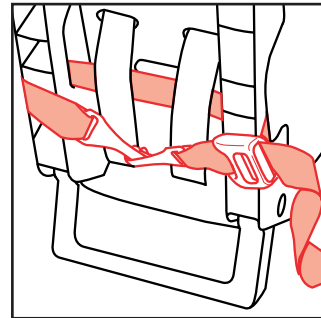

NOTE: Do not use the top anchorage strap in the rear-facing position. The top anchorage strap and hook should be placed under the child restraint.

When LATCH is not available, fasten belt hooks together behind the child restraint as shown.

⚠ WARNING:

A loose top anchorage (tether) strap can result in serious injury or death.

Loose LATCH hooks can result in serious injury or death.

Rear Facing Use: 5-35 lbs. (2.3-16 kg), 19-36" (48-91 cm)

Rear-Facing Installation with Vehicle Belt:

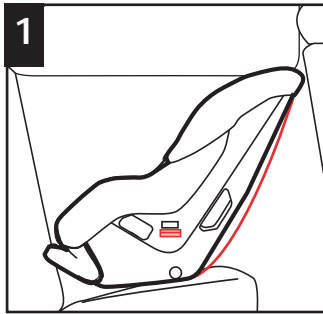

1 Connect and tighten harness straps prior to installing in vehicle. Place child restraint rear-facing in the back seat. With child restraint in the reclined position, make sure level line on side of shell is level with ground. Adjust child restraint if needed.

NOTE: Tuck the top anchorage strap's hook under the child restraint.

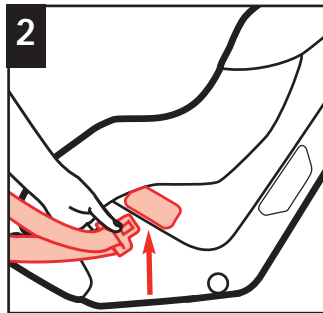

2 Thread the vehicle lap or lap/shoulder belt combination through the rear-facing belt slot.

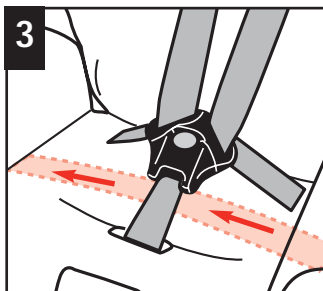

3 Thread UNDER seat pad between buckle strap and rear slots and out opposite side. Buckle vehicle belt.

Do not place vehicle belt over child's legs.

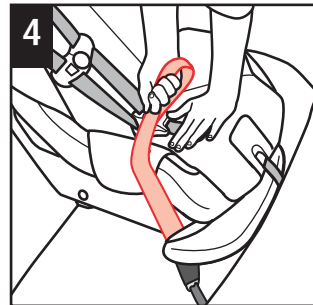

4 Push down firmly on the child restraint and pull up on belt to tighten. For a manual belt, refer to "Knowing your Vehicle Belt" section. Pull up on shoulder strap to remove any slack.

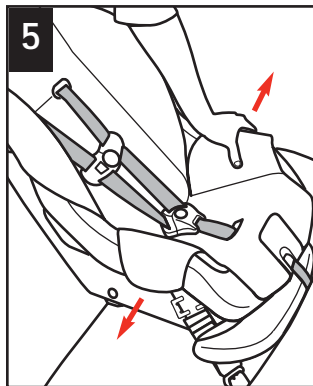

5 With weakest hand at belt path, tilt and push the child restraint forward and back, and from side to side. If the seat belts do not loosen, your child restraint should be secure.

NOTE: Some "play" from front to back or about an inch from side to side is acceptable. If it moves more, review "Knowing your Vehicle Belts" and "The Locking Clip" sections.

After checking for hot seat and buckles, secure child as described in "Securing Your Child in the Child Restraint" section.

NOTE: Locking clip is shown installed.

⚠ WARNING
Using this child restraint in any vehicle seat where the lap belt cannot be tightened securely and properly or where it can be loosened by pulling on it can result in serious injury or death.

Rear Facing Use: 5-35 lbs. (2.3-16 kg), 19-36" (48-91 cm)

Rear-Facing Installation with LATCH: Install LATCH Belt

NOTE: Do not use the LATCH system along with the adult lap or lap/shoulder belt.

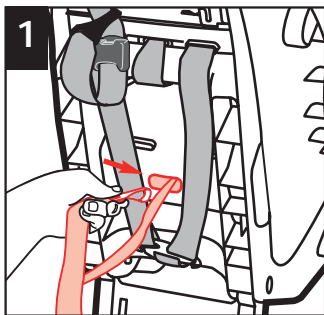

To thread LATCH belts:
From the back of child restraint, route entire LATCH belt through the hole in center of shell.

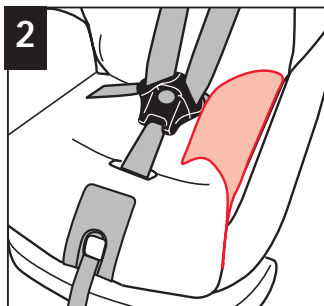

Pull the seat pad off the front corners of shell.

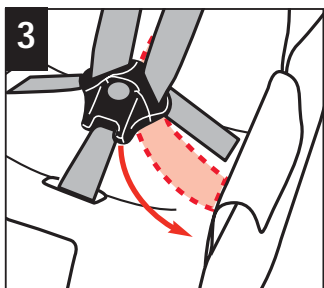

Reach under pad, pull one LATCH hook between rear harness slot and buckle strap.

NOTE: LATCH adjuster can be on either side, but belt should not be twisted.

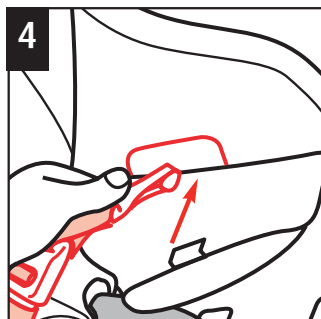

Push LATCH hook through the rear-facing belt path slot.

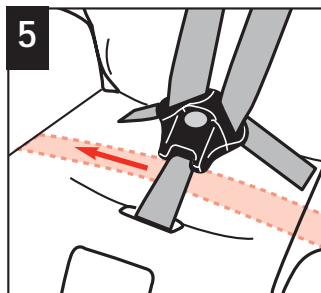

Pull other end of LATCH hook between buckle strap and rear harness slot.

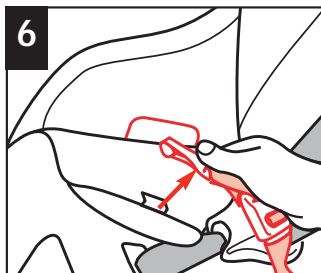

Push LATCH hook through the other rear-facing belt path slot.

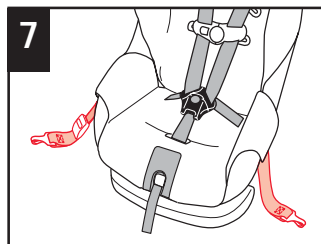

Put seat pad back over corners of shell.
Completed threading of the LATCH system.

Rear-Facing Installation with LATCH: Install in Vehicle

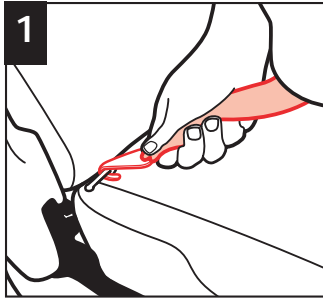

1 Connect and tighten harness straps prior to installing in vehicle. Place child restraint rear-facing in the back seat. **NOTE:** Tuck the top anchorage strap's hook under the child restraint. Fasten one LATCH belt hook to the anchor in the vehicle seat located in the vehicle seat bight. Repeat for other side of child restraint. See your vehicle owner's manual for more information.

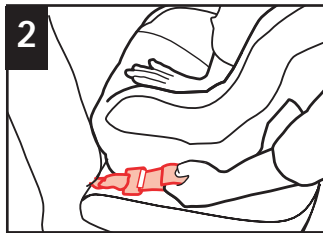

2 Push down firmly on the child restraint and pull up on the loop to tighten belt.

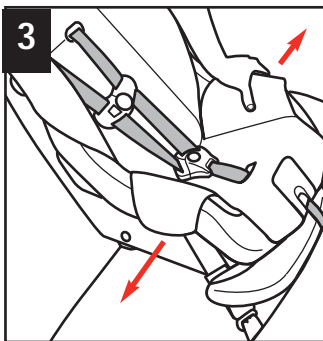

3 With weakest hand at belt path, tilt and push the child restraint forward and back, and from side to side. If the LATCH belts do not loosen, your child restraint should be secure.

NOTE: Some "play" from front to back or about an inch from side to side is acceptable.

If the child restraint does not remain tight, do not use the child restraint in this seating location with this LATCH system.

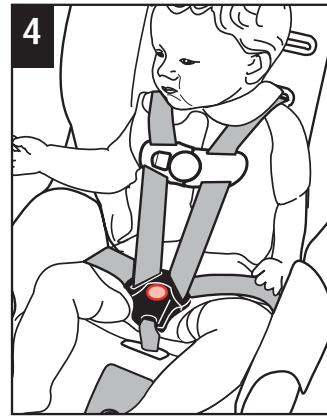

4 After checking for hot seat and buckles, place child in child restraint. See "Securing Your Child in the Child Restraint" section.

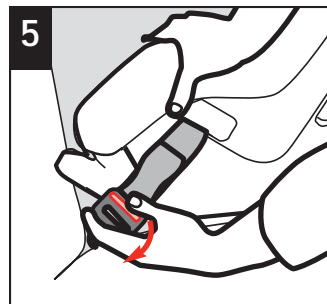

5 **To remove LATCH:** Remove child from restraint. Press down firmly on adjuster side of child restraint and push in on release button on adjuster to release tension as shown. Unhook LATCH from bar.

WARNING

LATCH hooks MUST be securely fastened. Failure to do this can result in serious injury or death.

Forward-Facing Use: 22-40 lbs. (10.1-18 kg), 34-43" (85.1-110 cm), Over 1 year of age.

Forward-Facing Use

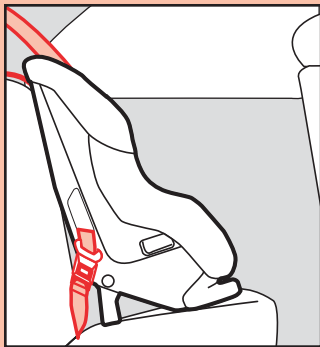

Lap/Shoulder Belt

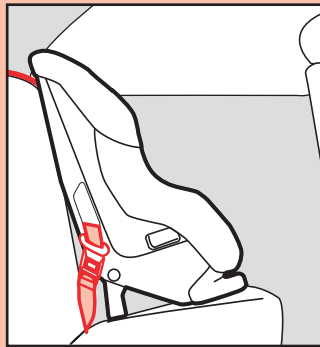

Lap Belt

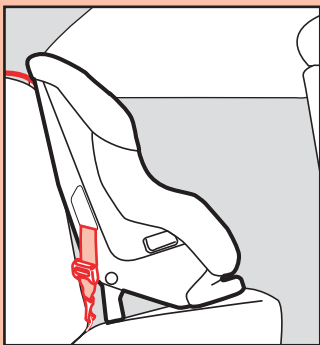

LATCH Belt

Refer to the "Choosing Restraint and Position" section to make sure your child is at the proper weight and height to face forward.

⚠WARNING:

Using this child restraint in any vehicle seat where the lap or LATCH belts cannot be tightened securely and properly or where it can be loosened by pulling on it can result in serious injury or death.

Check vehicle owner's manual for more information about airbag/child restraint use.

Forward-Facing Installation

After deciding whether to use your Vehicle Belts or LATCH, be sure to read the warnings below as they pertain to both systems.

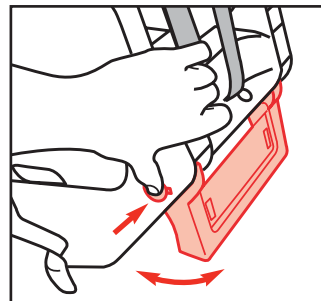

In the forward-facing position, the child restraint can be used in either reclined or upright position.

To fully recline, push in on red button on side of shell and rotate recline stand up into shell. Reverse for upright position.

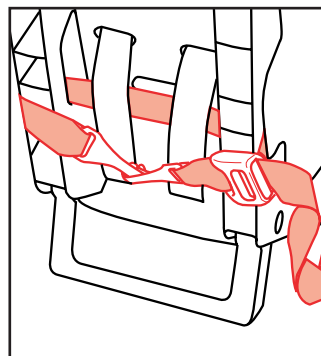

When LATCH is not being used, fasten belt hooks together behind the child restraint as shown.

⚠WARNING:

Loose LATCH hooks can result in serious injury or death.

Forward-Facing Use: 22-40 lbs. (10.1-18 kg), 34-43" (85.1-110 cm), Over 1 year of age.

Forward-Facing Installation with Vehicle Belts:

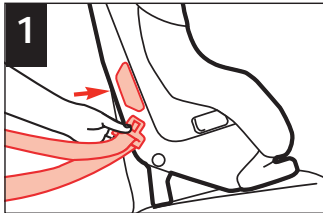

1 Connect and tighten harness straps prior to installing in vehicle. Place child restraint **flush** against the back of the vehicle seat **forward-facing** in the back seat.

The recline position is to be used only to install the child restraint flush against the back of the vehicle seat back, if needed.

Thread the vehicle lap belt or lap/shoulder belt combination through the belt path and out other side. Buckle.

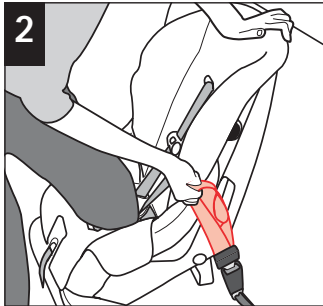

2 Place one knee in the child restraint and push down firmly while pulling up on belt to tighten. For a manual belt, refer to "Knowing your Vehicle Belt" section.

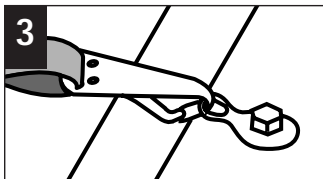

3 With knee still in child restraint, attach hook to anchor in vehicle. Push down firmly and tighten top anchorage strap.

To adjust top anchorage strap: See "Adjusting Top Anchorage Strap" section.

NOTE: If your vehicle does not have an anchor bracket, tuck the top anchorage strap's hook under the child restraint.

34

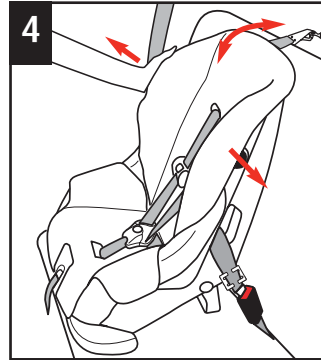

4 **NOTE:** Locking clip is shown installed.

With weakest hand at belt path, tilt and push the child restraint forward and back, and from side to side. If the seat belts do not loosen, your child restraint should be secure.

NOTE: Some "play" from front to back or about an inch from side to side is acceptable. If it moves more, review "Knowing Your Vehicle Belts" and "The Locking Clip" sections.

⚠ WARNING

Using this child restraint in any vehicle seat where the lap belt cannot be tightened securely and properly or where it can be loosened by pulling on it can result in serious injury or death.

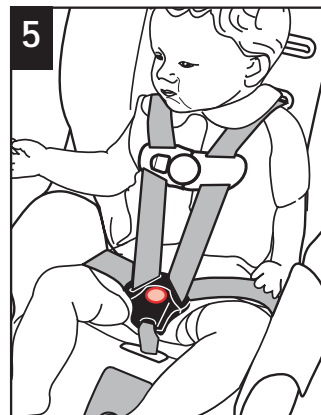

5 After checking for hot seat and buckles, place your child in the child restraint as described in the "Securing Your Child in the Child Restraint" section.

35

Forward-Facing Use: 22-40 lbs. (10.1-18 kg), 34-43" (85.1-110 cm), Over 1 year of age.

Forward-Facing Installation with LATCH Belt: Install LATCH Belts

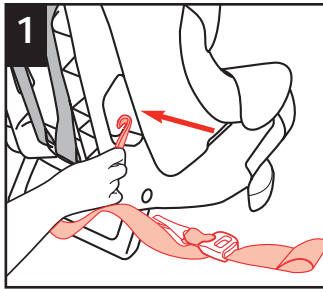

NOTE: Do not use LATCH system along with the adult lap or lap/shoulder belt.

Route LATCH belt through upper slot in side of shell.

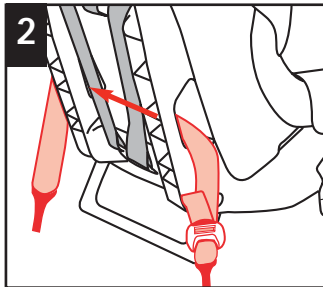

Pull one LATCH hook across the back and out the other side.

The LATCH adjuster can be on either side, but the belt should not be twisted.

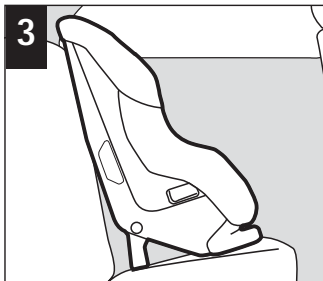

Connect and tighten harness straps prior to installing in vehicle. Place child restraint **flush** against the back of the vehicle seat **forward-facing** in the back seat. The recline position is to be used only to install the child restraint flush against the back of the vehicle seat back, if needed.

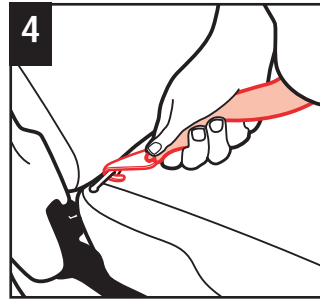

Fasten one LATCH belt hook to the anchor in the vehicle seat located in the vehicle seat bight. Repeat for other side of child restraint. See your vehicle owner's manual for locations and more information.

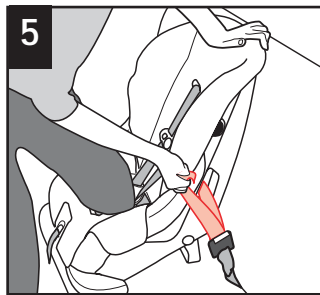

Place one knee in the child restraint and push down firmly while pulling up on the loop to tighten belt.

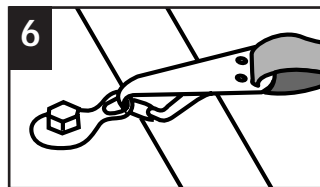

With knee still in child restraint, attach hook to anchor in vehicle. Push down firmly and tighten top anchorage strap.

To adjust top anchorage strap: See "Adjusting Top Anchorage Strap" section.

Forward-Facing Use: 22-40 lbs. (10.1-18 kg), 34-43" (85.1-110 cm), Over 1 year of age.

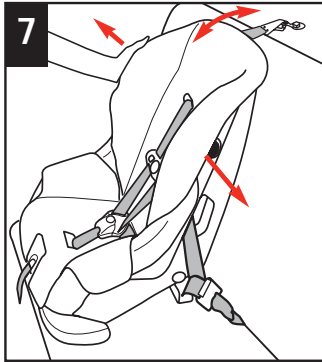

With weakest hand at belt path, tilt and push the child restraint forward and back, and from side to side. If the LATCH belts do not loosen, your child restraint should be secure.

NOTE: Some “play” from front to back or about an inch from side to side is

acceptable.

If the child restraint does not remain tight, do not use the child restraint in this seating location with this LATCH system.

⚠ WARNING

LATCH hooks MUST be securely fastened. Failure to do this can result in serious injury or death.



After checking for hot seat and buckles, place your child in the child restraint as described in the “Securing Your Child in the Child Restraint” section.

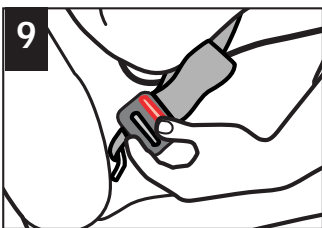

To remove LATCH: Push in on release button and pull LATCH adjuster away from child restraint to loosen. Unhook LATCH hooks.

Adjusting the Top Anchorage Strap

Review the 3 styles of top anchorage straps below and the next 2 pages to determine which style you have. Review label on top anchorage strap to verify your adjustment method.

The top anchorage strap is used for the forward-facing position only.

Most vehicles made after 9/1/99 already have the anchor hardware for a top anchorage strap. Refer to your owner’s manual or call your dealer.

Storage of Top Anchorage Strap:

Rear-facing position: Place top anchorage strap over the back of the child restraint with the anchor hook secured under the base or child restraint.

See pictures below and on next page to determine which top anchorage strap model you have. Follow applicable steps.

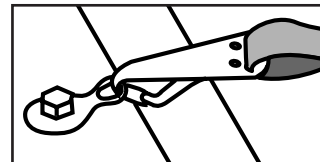

Style 1 - To Attach Top Anchorage Strap: Put knee in child restraint and push down; attach hook to anchor in vehicle.

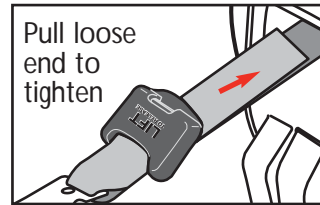

To Adjust Top Anchorage Strap: To tighten; pull on free end of top anchorage strap.

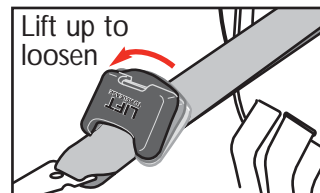

To loosen; lift up on top anchorage lock and push lock toward top anchorage hook.

Forward-Facing Use: 22-40 lbs. (10.1-18 kg), 34-43” (85.1-110 cm), Over 1 year of age.

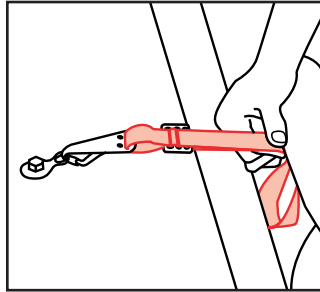

Style 2 - To Attach Top Anchorage Strap: Put knee in child restraint and push down; attach hook to anchor in vehicle to estimate how much adjustment you need, then unhook.

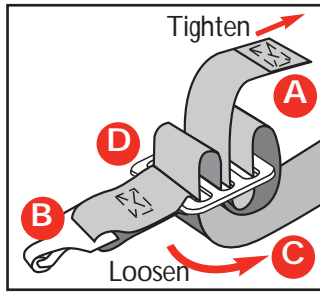

To Adjust Top Anchorage Strap: Loosen top anchorage strap into "loops" at adjuster slide as shown above.

To tighten top anchorage strap: Pull on free end (A) of top anchorage strap while holding hook (B).

To loosen top anchorage strap: Pull on lower top anchorage strap (C) while holding adjusting slide (D) with your other hand.

Pull on free end of top anchorage strap until the "loops" are flush against the adjuster. Reattach hook to anchor to check fit, repeat steps if needed.

⚠ WARNING

You must follow the threading diagram exactly. Failure to follow these steps could cause the strap to loosen in a crash, which can result in serious injury or death.

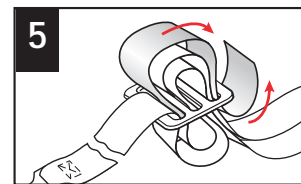
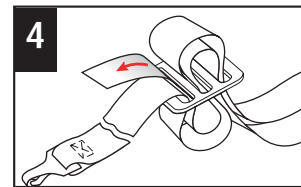
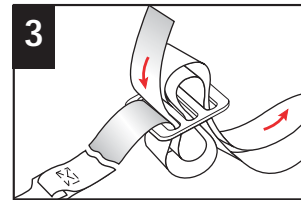
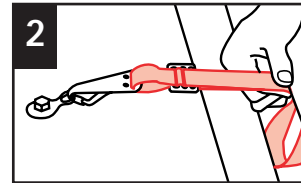
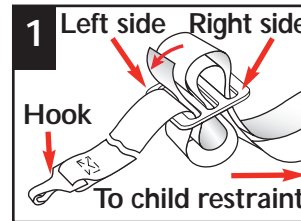

Style 3 - To Attach Top Anchorage Strap: At the adjuster, unlace free end of strap from right side of adjuster slide and loosen into "loops" (1). Put knee in child restraint and push down; attach hook to anchor to estimate how much you need, then unhook (2).

To loosen top anchorage strap: With adjuster in hand, pull the top strap (3) between adjuster and child restraint to desired length. Attach hook to anchor, check fit, repeat steps if necessary.

You must rethread the free end of strap back down through the right slot (5) or the tether will not hold. Tighten strap so "loops" are gone and there is no slack or play.

To tighten tether: With adjuster in hand, pull the top strap (4) between adjuster and hook to the desired length. Attach hook to anchor, check fit, repeat steps if necessary.

You must rethread the free end of strap back down through the right slot (5) or the tether will not hold.

Tighten strap so "loops" are gone and there is no slack or play.

⚠ WARNING

You must follow the threading diagram exactly. Failure to follow these steps could cause the strap to loosen in a crash, which can result in serious injury or death.

Forward-Facing Use: 22-40 lbs. (10.1-18 kg), 34-43" (85.1-110 cm), Over 1 year of age.

Removing Seat Pad for Cleaning

⚠ WARNING

Failure to use the child restraint without the seat pad can result in serious injury.

Removal of Harness:

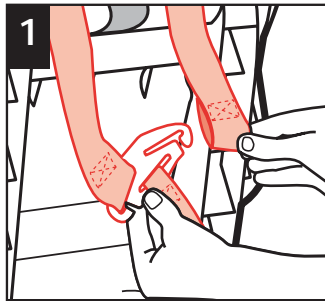

1 From the back of the seat, unfasten harness from splitter plate.

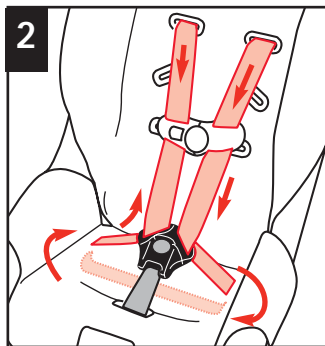

2 Pull harness through the slots from the front.

Unthread harness from the harness retainer.

Unthread harness from the buckle plates.

Pull harness out of shell.

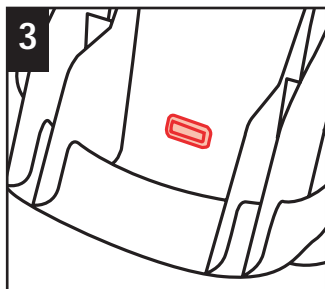

3 From bottom of seat, locate buckle's metal clip.

42



4 Insert metal clip up through the shell and pad. From the front, pull buckle free from shell and pad. Lock buckle plates into buckle and set aside harness system to reinstall after cleaning.

Removal of Pad:

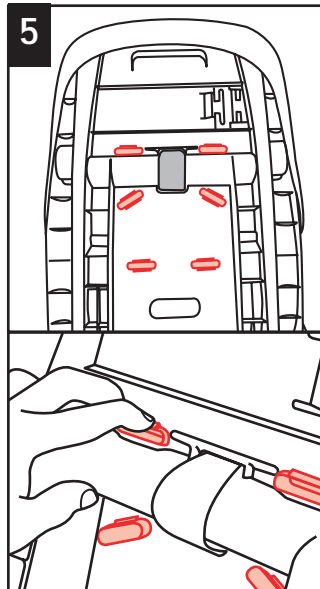

5 From back of shell, release the 6 harness guides shown in red by pushing down on one edge with one hand and pulling out from the front side with the other.

43

continued on next page.

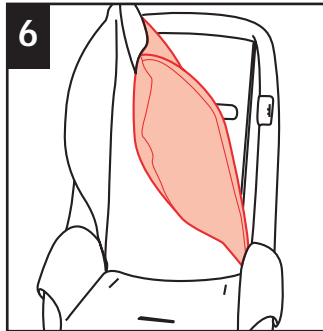

6 Pull pad off the shell, starting at the top. Remove pad from sides of shell.

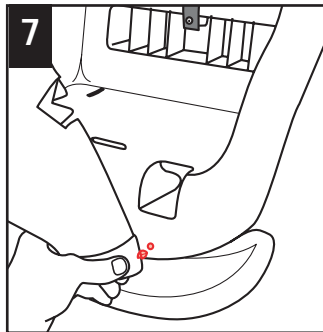

7 Unsnap the bottom of pad from shell. Clean with warm sudsy water, rinse clean and air dry. Do not use bleach or other harsh cleaners.

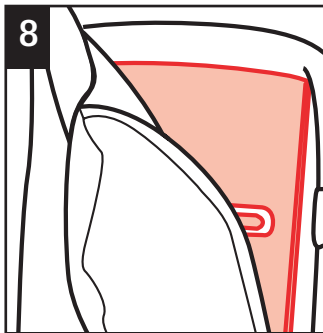

8 Replace seat pad by reversing order, starting from bottom of child restraint, snap pad on shell; tuck in pad around harness adjuster; attach pad to sides of shell. Make sure holes in foam pad align with harness guide holes before wrapping pad over top of shell. Replace the 6 harness guides.

Reinstall Harness

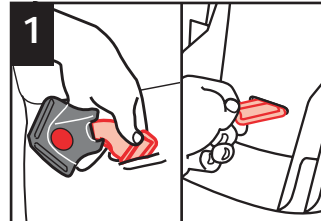

1 Fit the buckle strap down through the slot in the seat. Make sure buckle faces out. From the bottom of seat, pull buckle's metal clip completely through pad and shell.

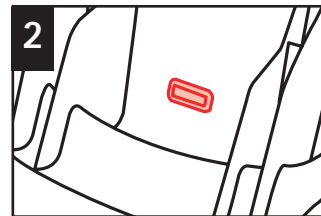

2 Pull up on buckle to make sure buckle's metal plate is completely through the pad and shell.

⚠ WARNING

Failure to place buckle's metal plate completely through pad and shell can result in serious injury or death to the child.

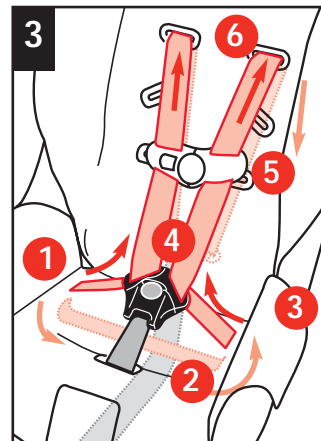

3 Thread the harness down through slot on left side of shell (1), across bottom of seat (2) and up through slot on right side (3).

Thread one buckle plate onto harness from back to front (4). Thread the harness retainer (5). Do the same to the other harness end. Make sure the harness is not twisted.

Push harness ends through upper slots in shell (6).

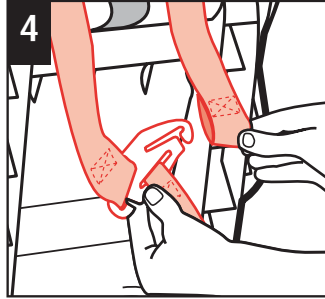

From the back of the seat, fasten harness to splitter plate.

⚠ WARNING

Failure to reattach the buckle and harness correctly, can result in serious injury or death.

Trouble Shooting

✓1. If your child restraint is not held securely by the belt:

Press down firmly on the child restraint and remove all the slack in the belt. Make sure the belt buckle is not up against the child restraint where the belt cannot be tightened. Review Locking Clip section and Top Anchorage Strap Section. If you cannot secure the child restraint tightly, move it to another seating location.

✓2. If the child restraint buckle or harness adjustment lever sticks or you cannot get the straps tight enough around child:

DO NOT LUBRICATE. Check around buckle and harness release lever for dropped food, sticky spilled drinks, dirt, leaves, etc. Clean with warm water and/or remove object with tweezers. If you cannot get the harness to adjust and remain tight with the buckle securely locked, do not use the child restraint.

✓3. If your harness twists or ropes:

Straighten the harness each time you put your child in the seat to help prevent twisting. Lock the buckle and tighten harness and it will be ready for next use.

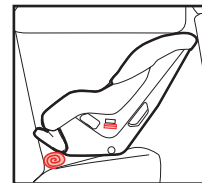

✓4. If your infant sits too upright in the rear-facing position:

If your vehicle seat slopes so much that your infant is sitting upright, you may place a rolled towel under the front of the child restraint so that the level line on the side of shell is level (horizontal).

Check often to be sure padding is still in place and the vehicle belt is tight.

⚠ WARNING

Using padding that tilts the child restraint farther back than the level-to-ground line can result in serious injury or death.

Warranty

Dorel Juvenile Group, Inc. (DJG) warrants this product to the original retail purchaser as follows:

This product is warranted against defective materials or workmanship for one year from the date of original purchase.

An original receipt is required to validate your warranty. DJG will, at its option, provide replacement parts or replace this product. DJG reserves the right to substitute if the part or model has been discontinued.

To make a claim under this warranty you may contact us at www.djgusa.com, fax us at 1-800-207-8182 24 hours a day, write to DJG, Consumer Relations Department, P O Box 2609, Columbus, IN 47202-2609, or call 1-800-544-1108 from 7:00 a.m. to 6:00 p.m. EST Monday through Thursday and from 7:00 a.m. to 4:30 p.m. on Friday. **Proof of purchase is required and shipping charges are the responsibility of the consumer.**

Warranty Limitations:

This warranty does not include damages which arise from misuse or abuse of this product.

Limitation of Damages:

The warranty and remedies as set forth are exclusive and in lieu of all others, oral or written, expressed or implied. In no event will DJG or the dealer selling this product be liable to you for any damages, including incidental or consequential damages, arising out of the use or inability to use this product.

Limitation of warranties and other warranty terms and state law rights:

Any implied warranties, including implied warranties of the merchantability and fitness for a particular purpose, shall be limited to the duration and terms of the express written warranty. Some states do not allow limitations as to how long an implied warranty lasts or the exclusion or limitation of incidental or consequential damages, so the above limitations may not apply to you. This warranty gives you specific legal rights, and you may have other rights, which vary from state to state. Neither DJG nor the dealer selling this product authorized any person to create for it any other warranty, obligation, or liability in connection with this product.

PLEASE COMPLETE AND MAIL THE PRE-ADDRESSED OWNER REGISTRATION CARD WITHIN (30) DAYS OF PURCHASE TO EXPEDITE WARRANTY CLAIMS AND TO VERIFY THE ORIGINAL DATE OF PURCHASE.

Replacement Parts Order Form

Complete the form below. Your model number with color code and manufacturer date code **MUST** be included on the form to ensure proper replacement parts. Your model number with color code and the date code can be found on a sticker on the side of child restraint. Payment in U.S. dollars must accompany your order. Choose parts needed from the next page.

Return the form with payment to:

Dorel Juvenile Group, Inc.
Consumer Relations Department
P.O. Box 2609
Columbus, IN 47202-2609

Fax orders to: 1-800-207-8182

Please make money orders payable to Dorel Juvenile Group, Inc. Fill in the area below to charge to Visa or Mastercard. We do not accept personal checks or Discover Card. All outside of U.S. and Canada **MUST** use credit card.

Ship To (Please Print): _____

Name: _____

Address: _____

City: _____

State/Province: _____ Zip _____

Telephone: _____

Email Address: _____

We **MUST have this information to process your order:**

Model Number (5 digits & 3 letters): _____

Manufacture Date (mm/dd/yyyy): _____